

# Ingombro parte metallica nella gomma

Misure reali

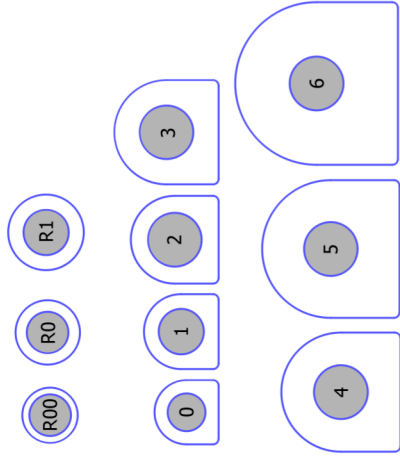

misure R00, R0, 0  
diametro inserto metallico (nella gomma) mm.5.5

misure R1, 1  
diametro inserto metallico (nella gomma) mm.6.0

misure 2, 3, 4, 5, 6  
diametro inserto metallico (nella gomma) mm.7.1

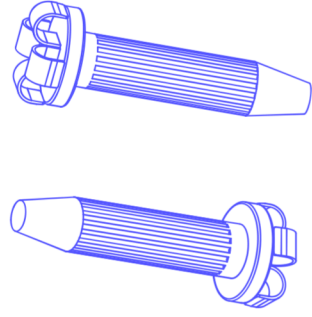

diametro gambo zigrinato:  
- mm.3  
- mm.2.50 (SLIM)

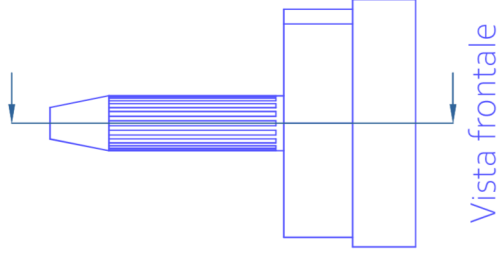

Vista frontale

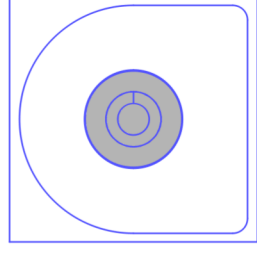

Vista dall'alto

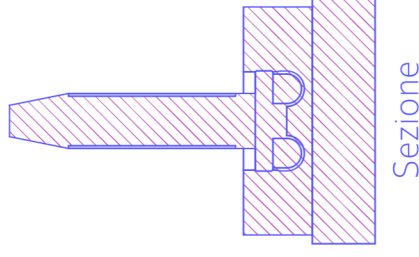

Sezione